

# RMP series male thread

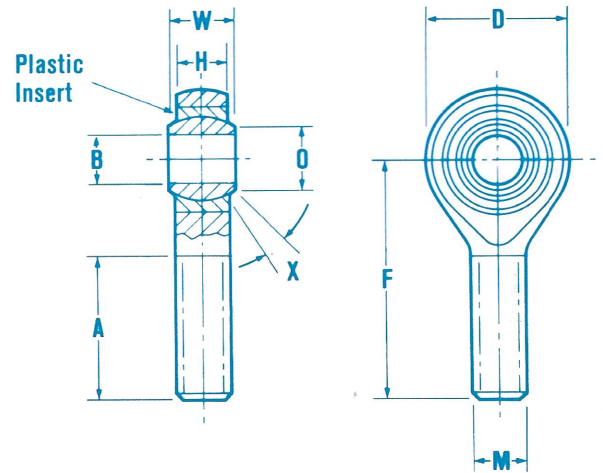

## Specification

<b>Housing</b>	Mild steel. Phosphated.
<b>Ball</b>	1% carbon chromium steel. Chromium plated on spherical surface.
<b>Liner</b>	Plastic – acetal copolymer.
<b>Temperature</b>	Normal operating range 0-75°C.



## Imperial dimensions

Bearing number	B	W	H	O	D	F	A	M	X	Ball dia	Maximum static radial load in pounds approx.	Weight in pounds approx.
	Bore +0015 -0005	Ball width +005 -005	Housing width +005 -005	Ball flat dia	Head dia +010 -010	Centre length +030 -030	Thread length +062 -031	Thread size UNF 2A	Angle deg.			
RMP 04U	.2500	.375	.311	.355	.812	1.562	1.000	.250-28	12.5	.515	900	.062
RMP 05U	.3125	.437	.374	.447	1.000	1.875	1.250	.312-24	10.5	.625	1,450	.094
RMP 06U	.3750	.500	.436	.517	1.125	1.938	1.218	.375-24	9.0	.718	2,100	.137
RMP 08U	.5000	.625	.530	.698	1.375	2.438	1.500	.500-20	9.0	.937	3,500	.281

For left hand thread insert 'L' in bearing number, eg. RMLP 06U.